



Howarth Way

St. Crispin, Northampton

oriordanbond
SALES & LETTINGS



GROUND FLOOR
406 sq.ft. (37.7 sq.m.) approx.

1ST FLOOR
406 sq.ft. (37.7 sq.m.) approx.

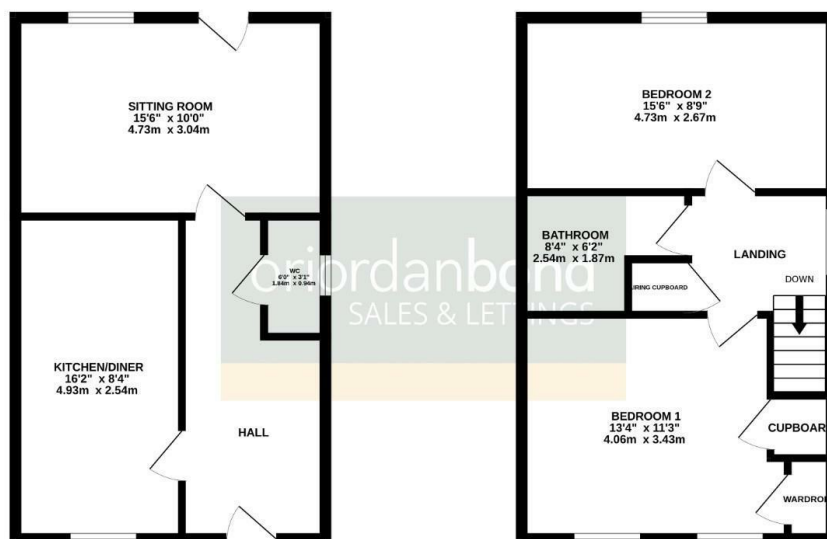

TOTAL FLOOR AREA: 812 sq.ft. (75.5 sq.m.) approx.

Whilst every attempt has been made to ensure the accuracy of the floorplan contained here, measurements of doors, windows, rooms and any other items are approximate and no responsibility is taken for any error, omission or mis-statement. This plan is for illustrative purposes only and should be used as such by any prospective purchaser. The services, systems and appliances shown have not been tested and no guarantee as to their operability or efficiency can be given.
Made with: Metreplan C0206

Howarth Way

St. Crispin

NN5 4AA

55% SHARED OWNERSHIP £137,500

Offered to the market on a 55% shared ownership basis is this two bedroom semi-detached house. The property is presented to a great standard having been re-decorated throughout and is located in the desirable area of St. Crispin.

The accommodation comprises entrance hall, sitting room, kitchen/dining room and cloakroom/WC, two first floor double bedrooms and a family bathroom. Outside is a well maintained rear garden and off road parking for two vehicles to the front. Further benefits include uPVC double glazing and gas radiator heating. (B/812/S)

Leasehold Information: Lease Remaining - 88 years (as of 2026) / Rent on Remaining Share - £280.00 pcm

Additional information

- Council Tax Band: C
- Energy Efficiency Rating:

Viewing

Viewing strictly by appointment – details below

Disclaimer

O'Riordan Bond Estate Agents Limited has not tested apparatus, equipment, fittings or services and so cannot verify they are in working order. The buyer is advised to obtain verification from their solicitor or surveyor.

O'Riordan Bond Duston Sales

01604 589007

duston@oriordanbond.co.uk

